

SOLID-STATE TIMING RELAY WITH WYE-DELTA FUNCTION,
 1 NO DELAYED, 1 NO INSTANTANEOUS,
 1 TIME SETTING RANGE 1...20S,
 24V AC/DC AND 100...127V AC,
 SCREW TERMINAL MULTI-UNIT PACK,
 1 PACK = 48 UNITS

General technical details:

product brand name		SIRIUS
product designation		timing relay
Protection class IP / on the front		IP40
Protection class IP / of the terminal		IP20
mounting position		any
Supply voltage frequency		
<ul style="list-style-type: none"> • 1 / for auxiliary and control current circuit <ul style="list-style-type: none"> • initial rated value • final rated value 	Hz Hz	50 60
Product function		
<ul style="list-style-type: none"> • star-delta circuit • with auxiliary voltage / pulse-shaping • at the relay outputs / changeover delayed/without delay 		Yes No No
Product component / semi-conductor output		No
Product extension / optional / remote control		No
Product extension / strictly required / remote control		No
Installation altitude / at a height over sea level / maximum	m	2,000
Ambient temperature		
<ul style="list-style-type: none"> • during storage • during operating • during transport 	°C °C °C	-40 ... +85 -25 ... +60 -40 ... +85
Relative humidity		
<ul style="list-style-type: none"> • during operating phase 	%	15 ... 70
Conductor-bound parasitic coupling BURST / according to IEC 61000-4-4		2 kV network connection / 1 kV control connection
Conductor-bound parasitic coupling conductor-earth SURGE / according to IEC 61000-4-5		2 kV
Conductor-bound parasitic coupling conductor-conductor SURGE / according to IEC 61000-4-5		1 kV

Electrostatic discharge / according to IEC 61000-4-2		4 kV contact discharge / 8 kV air discharge
Field-bound parasitic coupling / according to IEC 61000-4-3		10 V/m
Resistance against vibration		10 ... 55 Hz / 0.35 mm
Impulse voltage resistance / rated value	V	4,000
Insulation voltage / rated value	V	300
Active power loss / total / typical	W	2
Item designation / according to DIN 40719 extendable after IEC 204-2 / according to IEC 750		K
Item designation / according to DIN EN 61346-2		K
Category / according to EN 954-1		none
Protection against electrical shock		finger-safe

Switching Function:

Switching function

• slow-operating	No
• making pulse contact	No
• firmly clocked beginning with pulse	No
• firmly clocked beginning with pause	No
• relapse delayed	No
• variably clocked start with impulse	No
• impuls variably clocked start with pause	No
• with auxiliary voltage	
• in an additive way slow-operating	No
• temporary line fault	No
• relapse delayed	No
• without auxiliary voltage / relapse delayed	No
• slow-operating/instantaneous contact	No
• with auxiliary voltage	
• relapse delayed/instantaneous contact	No
• slow-operating/relapse delayed/instantaneous contact	No
• firmly clocked beginning with pause/instantaneous contact	No
• making pulse contact/instantaneous contact	No
• with auxiliary voltage	
• temporary line fault/instantaneous contact	No
• pulse modelling/instantaneous contact	No
• slow-operating/instantaneous contact	No

General details:

Type of voltage / of the controlled supply voltage		AC/DC
Control supply voltage frequency		
• 1	Hz	50 ... 60

Control supply voltage		
• 1		
• at 50 Hz / for AC / rated value	V	24
• at 60 Hz / for AC / rated value	V	24
• for DC / rated value	V	24
• 2		
• at 50 Hz		
• for AC	V	100 ... 127
• at 60 Hz		
• for AC	V	100 ... 127
Operating range factor control supply voltage rated value		
• at 50 Hz		
• for AC		0.85 ... 1.1
• at 60 Hz		
• for AC		0.85 ... 1.1
• for DC		0.85 ... 1.1

Auxiliary circuit:

Operating current / of auxiliary contacts		
• as normally closed contact / for AC-15		
• at 24 V	A	3
• at 250 V	A	3
• as normally open contact / for AC-15		
• at 24 V	A	3
• at 250 V	A	3
• at AC-15		
• maximum	A	3
• at DC-13		
• at 24 V	A	1
• at 125 V	A	0.2
• at 250 V	A	0.1
Number of NC contacts / delayed switching		0
Number of NC contacts / non-delayed		0
Number of NO contacts / delayed switching		1
Number of NO contacts / non-delayed		1
Number of change-over switches / delayed switching		0
Number of change-over switches / non-delayed		0

Short-circuit:

Design of the fuse link / for short-circuit protection of the auxiliary switch / required		fuse gL/gG: 4 A
--	--	-----------------

Type of mounting		screw and snap-on mounting onto 35 mm standard mounting rail
Installation/mounting/dimensions:		
Width	mm	22.5
Height	mm	83
Depth	mm	91
Distance, to be maintained, to the ranks assembly		
• upwards	mm	0
• forwards	mm	0
• sideways	mm	0
• backwards	mm	0
• downwards	mm	0
Distance, to be maintained, to earthed part		
• backwards	mm	0
• sideways	mm	0
• upwards	mm	0
• forwards	mm	0
• downwards	mm	0
Distance, to be maintained, conductive elements		
• downwards	mm	0
• backwards	mm	0
• sideways	mm	0
• forwards	mm	0
• upwards	mm	0
Connections:		
Design of the snap-on socket base		none
Design of the electrical connection		No screw-type terminals
Type of the connectable conductor cross-section / for auxiliary contacts / solid		0.5 ... 4 mm ² , 2x (0.5 ... 2.5 mm ²)
Conductor cross-section that can be connected / for auxiliary contact / solid		
• minimum	mm ²	0.5
• maximum	mm ²	4
Type of the connectable conductor cross-section / for auxiliary contacts / finely stranded / with conductor end processing		0.5 ... 2.5 mm ² , 2x (0.5 ... 1.5 mm ²)
Conductor cross-section that can be connected / for auxiliary contact / finely stranded / with conductor end processing		
• minimum	mm ²	0.5

• maximum	mm ²	2.5
Type of the connectable conductor cross-section / for AWG conductors / for auxiliary contacts		2x (20 ... 14)
AWG number / as coded connectable conductor cross-section / for auxiliary contact		
• minimum		20
• maximum		14

Certificates/approvals:

Verification of suitability

CE / UL / CSA

General Product Approval

Declaration of Conformity

Test Certificates



CCC



CSA



GOST



UL



EG-Konf.

[Special Test Certificate](#)

Shipping Approval



BUREAU
VERITAS



DNV



GL



LRS



PRS



RINA

Shipping Approval

other



RMRS

[Confirmation](#)

[other](#)

[Environmental Confirmations](#)

Further information:

Information- and Downloadcenter (Catalogs, Brochures,...)

<http://www.siemens.com/industrial-controls/catalogs>

Industry Mall (Online ordering system)

<http://www.siemens.com/industrial-controls/mall>

CAX-Online-Generator

<http://www.siemens.com/cax>

Service&Support (Manuals, Certificates, Characteristics, FAQs,...)

<http://support.automation.siemens.com/WW/view/en/3RP1574-1NQ30-ZW97/all>

Image database (product images, 2D dimension drawings, 3D models, device circuit diagrams, ...)

http://www.automation.siemens.com/bilddb/cax_en.aspx?mlfb=3RP1574-1NQ30-ZW97

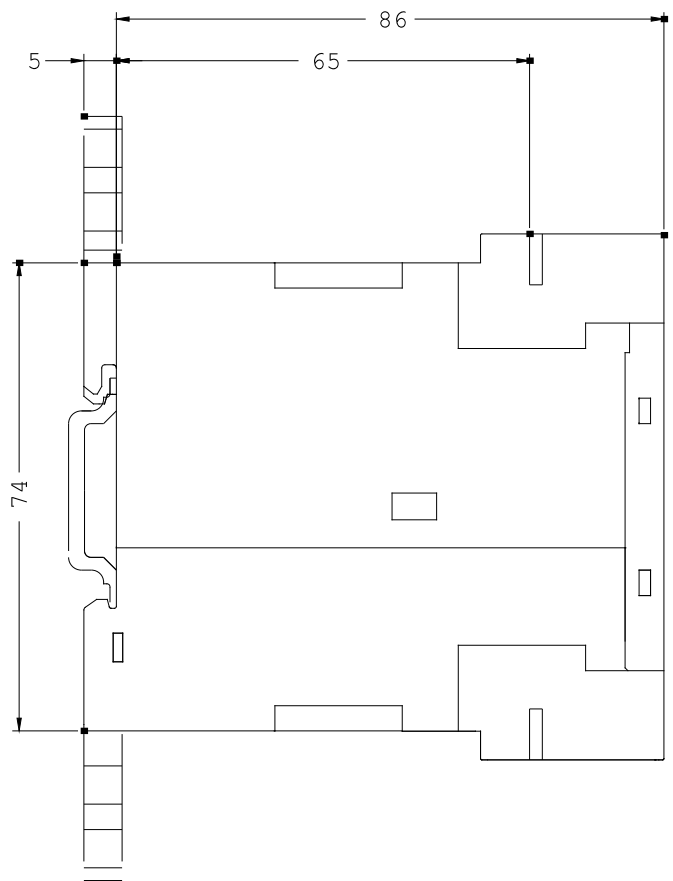
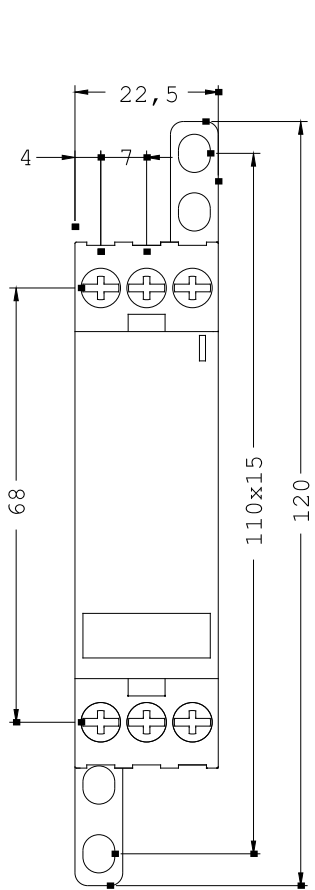

last change:

Feb 4, 2013