

TIME RELAY SOLID-STATE,
WITH STAR-DELTA FUNCTION,
1 NO CONTACT DELAYED,
1 NO CONTACT DELAYED 1 TIME DOMAIN 1...20 S
200...240V AC AND 380...440V AC SPRING TERMINAL

| General technical details: | | |
|---|----------------|---|
| product brand name | | SIRIUS |
| product designation | | timing relay |
| Protection class IP / on the front | | IP40 |
| Protection class IP / of the terminal | | IP20 |
| mounting position | | any |
| Supply voltage frequency | | |
| <ul style="list-style-type: none"> • 1 / for auxiliary and control current circuit • initial rated value • final rated value | Hz Hz | 50 60 |
| Product function | | |
| <ul style="list-style-type: none"> • star-delta circuit • with auxiliary voltage / pulse-shaping • at the relay outputs / changeover delayed/without delay | | Yes No No |
| Product component / semi-conductor output | | Yes |
| Product extension / optional / remote control | | No |
| Product extension / strictly required / remote control | | No |
| Installation altitude / at a height over sea level / maximum | m | 2,000 |
| Ambient temperature | | |
| <ul style="list-style-type: none"> • during storage • during operating • during transport | °C °C °C | -40 ... +85 -25 ... +60 -40 ... +85 |
| Relative humidity | | |
| <ul style="list-style-type: none"> • during operating phase | % | 15 ... 70 |
| Conductor-bound parasitic coupling BURST / according to IEC 61000-4-4 | | 2 kV network connection / 1 kV control connection |
| Conductor-bound parasitic coupling conductor-earth SURGE / according to IEC 61000-4-5 | | 2 kV |
| Conductor-bound parasitic coupling conductor-conductor SURGE / according to IEC 61000-4-5 | | 1 kV |
| Electrostatic discharge / according to IEC 61000-4-2 | | 4 kV contact discharge / 8 kV air discharge |

| | | |
|--|---|------------------------|
| Field-bound parasitic coupling / according to IEC 61000-4-3 | | 10 V/m |
| Resistance against vibration | | 10 ... 55 Hz / 0.35 mm |
| Impulse voltage resistance / rated value | V | 4,000 |
| Insulation voltage / rated value | V | 300 |
| Active power loss / total / typical | W | 2 |
| Item designation / according to DIN 40719 extendable after IEC 204-2 / according to IEC 750 | | K |
| Item designation / according to DIN EN 61346-2 | | K |
| Category / according to EN 954-1 | | none |
| Protection against electrical shock | | finger-safe |

Switching Function:

Switching function

| | |
|---|----|
| • slow-operating | No |
| • making pulse contact | No |
| • firmly clocked beginning with pulse | No |
| • firmly clocked beginning with pause | No |
| • relapse delayed | No |
| • variably clocked start with impulse | No |
| • impuls variably clocked start with pause | No |
| • with auxiliary voltage | |
| • in an additive way slow-operating | No |
| • temporary line fault | No |
| • relapse delayed | No |
| • without auxiliary voltage / relapse delayed | No |
| • slow-operating/instantaneous contact | No |
| • with auxiliary voltage | |
| • relapse delayed/instantaneous contact | No |
| • slow-operating/relapse delayed/instantaneous contact | No |
| • firmly clocked beginning with pause/instantaneous contact | No |
| • making pulse contact/instantaneous contact | No |
| • with auxiliary voltage | |
| • temporary line fault/instantaneous contact | No |
| • pulse modelling/instantaneous contact | No |
| • slow-operating/instantaneous contact | No |

General details:

| | | |
|---|----|-----------|
| Type of voltage / of the controlled supply voltage | | AC |
| Control supply voltage frequency | | |
| • 1 | Hz | 50 ... 60 |
| Control supply voltage | | |

| | | |
|--|---|--------------|
| <ul style="list-style-type: none"> • 1 <ul style="list-style-type: none"> • at 50 Hz <ul style="list-style-type: none"> • for AC • at 60 Hz <ul style="list-style-type: none"> • for AC • 2 <ul style="list-style-type: none"> • at 50 Hz <ul style="list-style-type: none"> • for AC • at 60 Hz <ul style="list-style-type: none"> • for AC | V | 200 ... 240 |
| | V | 200 ... 240 |
| | V | 380 ... 440 |
| | V | 380 ... 440 |
| Operating range factor control supply voltage rated value | | |
| <ul style="list-style-type: none"> • at 50 Hz <ul style="list-style-type: none"> • for AC • at 60 Hz <ul style="list-style-type: none"> • for AC • for DC | | 0.85 ... 1.1 |
| | | 0.85 ... 1.1 |
| | | 0.85 ... 1.1 |

Auxiliary circuit:

| | | |
|--|---|-----|
| Operating current / of auxiliary contacts | | |
| <ul style="list-style-type: none"> • as normally closed contact / for AC-15 <ul style="list-style-type: none"> • at 24 V • at 250 V • as normally open contact / for AC-15 <ul style="list-style-type: none"> • at 24 V • at 250 V • at AC-15 <ul style="list-style-type: none"> • maximum • at DC-13 <ul style="list-style-type: none"> • at 24 V • at 125 V • at 250 V | A | 3 |
| | A | 3 |
| | A | 3 |
| | A | 3 |
| | A | 3 |
| | A | 1 |
| | A | 0.2 |
| | A | 0.1 |
| Number of NC contacts / delayed switching | | 0 |
| Number of NC contacts / non-delayed | | 0 |
| Number of NO contacts / delayed switching | | 1 |
| Number of NO contacts / non-delayed | | 1 |
| Number of change-over switches / delayed switching | | 0 |
| Number of change-over switches / non-delayed | | 0 |

Short-circuit:

| | | |
|--|--|-----------------|
| Design of the fuse link / for short-circuit protection of the auxiliary switch / required | | fuse gL/gG: 4 A |
|--|--|-----------------|

| | | |
|---|-----------------|--|
| Type of mounting | | screw and snap-on mounting onto 35 mm standard mounting rail |
| Installation/mounting/dimensions: | | |
| Width | mm | 22.5 |
| Height | mm | 84 |
| Depth | mm | 91 |
| Distance, to be maintained, to the ranks assembly | | |
| • upwards | mm | 0 |
| • forwards | mm | 0 |
| • sideways | mm | 0 |
| • backwards | mm | 0 |
| • downwards | mm | 0 |
| Distance, to be maintained, to earthed part | | |
| • backwards | mm | 0 |
| • sideways | mm | 0 |
| • upwards | mm | 0 |
| • forwards | mm | 0 |
| • downwards | mm | 0 |
| Distance, to be maintained, conductive elements | | |
| • downwards | mm | 0 |
| • backwards | mm | 0 |
| • sideways | mm | 0 |
| • forwards | mm | 0 |
| • upwards | mm | 0 |
| Connections: | | |
| Design of the snap-on socket base | | none |
| Design of the electrical connection | | No spring-loaded terminals |
| Type of the connectable conductor cross-section / for auxiliary contacts / solid | | 2x (0.25 ... 1.5 mm ²) |
| Conductor cross-section that can be connected / for auxiliary contact / solid | | |
| • minimum | mm ² | 0.25 |
| • maximum | mm ² | 1.5 |
| Type of the connectable conductor cross-section / for auxiliary contacts / finely stranded / with conductor end processing | | 2x (0.25 ... 1.5 mm ²) |
| Conductor cross-section that can be connected / for auxiliary contact / finely stranded / with conductor end processing | | |
| • minimum | mm ² | 0.25 |

| | | |
|---|-----------------|------------------------------------|
| • maximum | mm ² | 1.5 |
| Type of the connectable conductor cross-section / for auxiliary contacts / finely stranded / without conductor final cutting | | 2x (0.25 ... 1.5 mm ²) |
| Conductor cross-section that can be connected / for auxiliary contact / finely stranded / without conductor final cutting | | |
| • minimum | mm ² | 0.25 |
| • maximum | mm ² | 1.5 |
| Type of the connectable conductor cross-section / for AWG conductors / for auxiliary contacts | | 2x (24 ... 16) |
| AWG number / as coded connectable conductor cross-section / for auxiliary contact | | |
| • minimum | | 24 |
| • maximum | | 16 |

Certificates/approvals:

Verification of suitability

CE / UL / CSA

General Product Approval

Declaration of Conformity

Test Certificates



CCC



CSA



GOST



UL



EG-Konf.

[Special Test Certificate](#)

Shipping Approval



BUREAU
VERITAS



DNV



GL



PRS



RINA



RMRS

other

[Confirmation](#)

[other](#)

[Environmental Confirmations](#)

Further information:

Information- and Downloadcenter (Catalogs, Brochures,...)

<http://www.siemens.com/industrial-controls/catalogs>

Industry Mall (Online ordering system)

<http://www.siemens.com/industrial-controls/mall>

CAX-Online-Generator

<http://www.siemens.com/cax>

Service&Support (Manuals, Certificates, Characteristics, FAQs,...)

<http://support.automation.siemens.com/VW/view/en/3RP1574-2NM20/all>

Image database (product images, 2D dimension drawings, 3D models, device circuit diagrams, ...)

http://www.automation.siemens.com/bilddb/cax_en.aspx?mlfb=3RP1574-2NM20

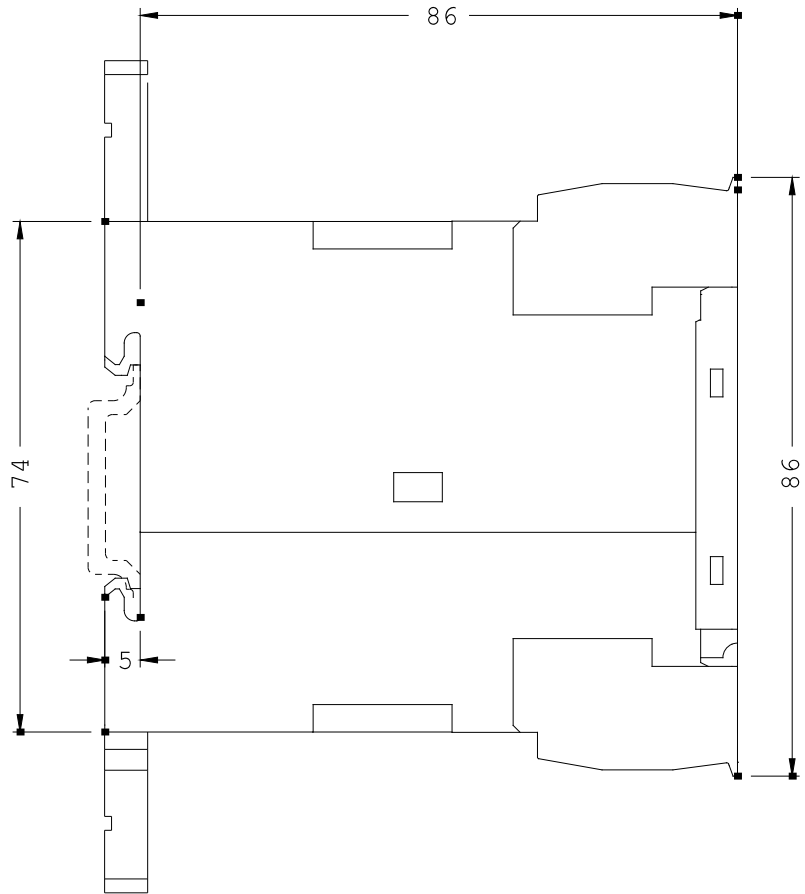
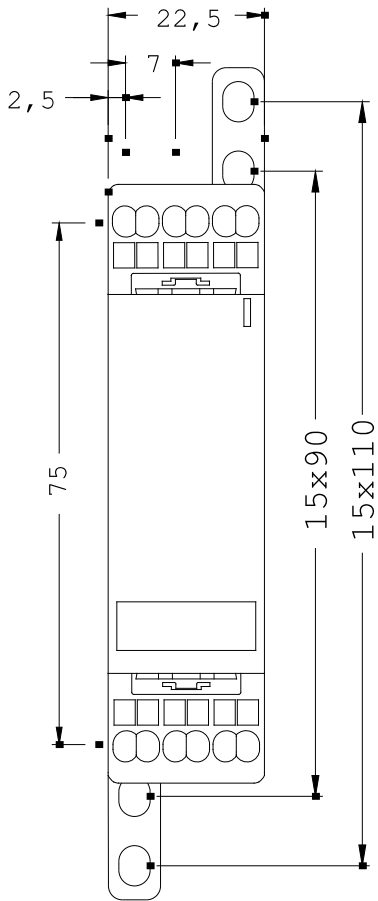

last change:

Feb 4, 2013