



TEMPERATURE MONITORING RELAY PT100/1000
 KTY83/84,
 NTC 2 THRESH. VAL.,
 DIGITAL -50 C - 500 C,
 24-240V AC/DC 2 X 1 W + 1 NO,
 WIDTH 45 MM CAGE-CLAMP - CONNECTION

General technical details:



type of voltage		AC/DC
Supply voltage frequency		
<ul style="list-style-type: none"> • 1 / for auxiliary and control current circuit <ul style="list-style-type: none"> • initial rated value • final rated value • 1 / at 50 Hz / for AC / initial rated value • 1 / at 50 Hz / for AC / final rated value • 1 / at 60 Hz / for AC / initial rated value • 1 / at 60 Hz / for AC / final rated value • 1 / for DC / initial rated value • 1 / for DC / final rated value 	<ul style="list-style-type: none"> Hz Hz V V V V V V 	<ul style="list-style-type: none"> 50 60 24 240 24 240 24 240
Number of measuring circuits		1
Product function		
<ul style="list-style-type: none"> • defect storage • reset external 		<ul style="list-style-type: none"> Yes Yes
Measurable temperature		
<ul style="list-style-type: none"> • initial value • final value 	<ul style="list-style-type: none"> °C °C 	<ul style="list-style-type: none"> -50 500
Item designation / according to DIN EN 61346-2		K

Item designation / according to DIN 40719 extendable after IEC 204-2 / according to IEC 750		K
Ambient temperature • during operating	°C	-25 ... +60

Mechanical design:

Design of the electrical connection • for auxiliary and control current circuit • jumper socket		spring-loaded terminals Yes
Design of the sensor / connectable		PT100/1000, KTY83/84, NTC (resistance sensors)
Number of NC contacts / for auxiliary contacts		0
Number of NO contacts / for auxiliary contacts		1
Number of change-over switches / for auxiliary contacts		2
Width	mm	45
Height	mm	108
Depth	mm	91

Certificates/approvals:

General Product Approval			Test Certificates	other	
			Special Test Certificate	Declaration of Conformity	Environmental Confirmations
CCC	GOST	UL			

Further information:

Information- and Downloadcenter (Catalogs, Brochures,...)

<http://www.siemens.com/industrial-controls/catalogs>

Industry Mall (Online ordering system)

<http://www.siemens.com/industrial-controls/mall>

Cax online generator:

<http://www.siemens.com/cax>

Service&Support (Manuals, Certificates, Characteristics, FAQs,...)

<http://support.automation.siemens.com/WW/view/en/3RS1040-2GW50/all>

Image database (product images, 2D dimension drawings, 3D models, device circuit diagrams, ...)

http://www.automation.siemens.com/bilddb/cax_en.aspx?mlfb=3RS1040-2GW50

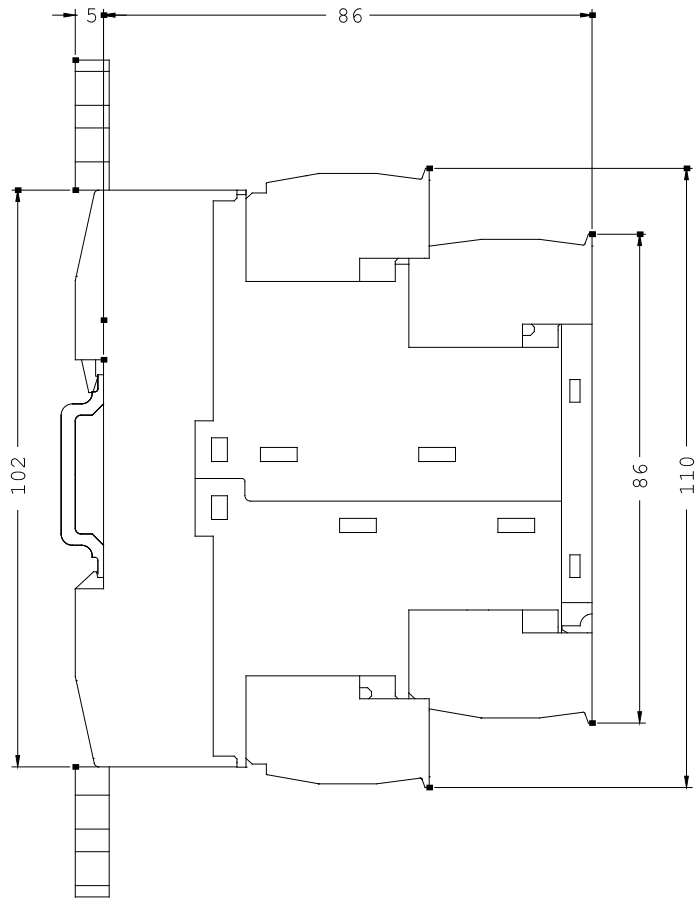
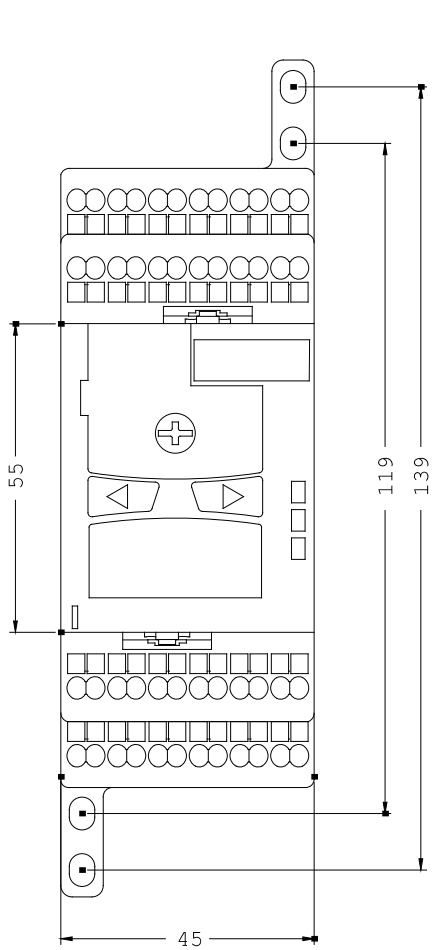

last change:

Jan 25, 2013