



TEMPERATURE MONITORING RELAY PT100/1000
 KTY83/84,
 NTC, 2 THRESHOLDS, DIGITAL,
 -50 DEGREES C TO 750 DEGREES C (SENSOR-
 DEPENDENT),
 24 V AC/DC, 2 X 1 CO + 1 NO,
 WIDTH 45 MM, SPRING-LOADED TERMINAL

General technical details:

type of voltage		AC/DC
Supply voltage frequency		
<ul style="list-style-type: none"> • 1 / for auxiliary and control current circuit 		
<ul style="list-style-type: none"> • initial rated value 	Hz	50
<ul style="list-style-type: none"> • final rated value 	Hz	60
<ul style="list-style-type: none"> • 1 / at 50 Hz / for AC / rated value 	V	24
<ul style="list-style-type: none"> • 1 / at 60 Hz / for AC / rated value 	V	24
<ul style="list-style-type: none"> • 1 / for DC / rated value 	V	24
Number of measuring circuits		1
Product function		
<ul style="list-style-type: none"> • defect storage 		Yes
<ul style="list-style-type: none"> • reset external 		Yes
Measurable temperature		
<ul style="list-style-type: none"> • initial value 	°C	-50
<ul style="list-style-type: none"> • final value 	°C	750
Item designation / according to DIN EN 61346-2		K
Item designation / according to DIN 40719 extendable after IEC 204-2 / according to IEC 750		K
Ambient temperature		
<ul style="list-style-type: none"> • during operating 	°C	-25 ... +60

Mechanical design:

Design of the electrical connection

- for auxiliary and control current circuit
- jumper socket

spring-loaded terminals

Yes

Design of the sensor / connectable

PT100/1000, KTY83/84, NTC (resistance sensors)

Number of NC contacts / for auxiliary contacts

0

Number of NO contacts / for auxiliary contacts

1

Number of change-over switches / for auxiliary contacts

2

Width

mm 45

Height

mm 108

Depth

mm 91

Certificates/approvals:

General Product Approval



CCC



GOST



UL

other

[Declaration of Conformity](#)

[Environmental Confirmations](#)

Further information:

Information- and Downloadcenter (Catalogs, Brochures,...)

<http://www.siemens.com/industrial-controls/catalogs>

Industry Mall (Online ordering system)

<http://www.siemens.com/industrial-controls/mall>

Cax online generator:

<http://www.siemens.com/cax>

Service&Support (Manuals, Certificates, Characteristics, FAQs,...)

<http://support.automation.siemens.com/WW/view/en/3RS1042-2GD70/all>

Image database (product images, 2D dimension drawings, 3D models, device circuit diagrams, ...)

http://www.automation.siemens.com/bilddb/cax_en.aspx?mlfb=3RS1042-2GD70

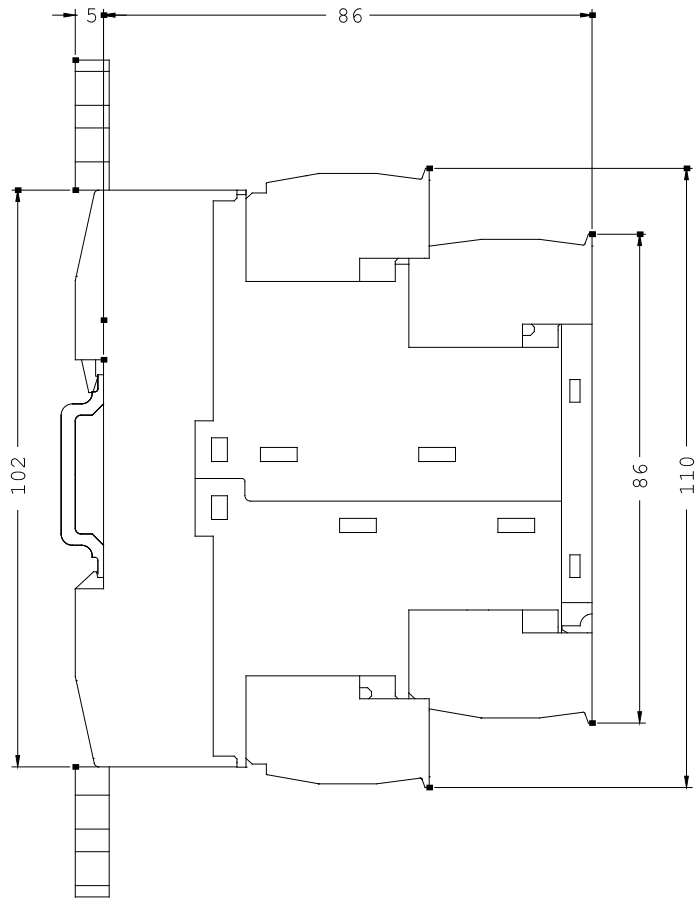
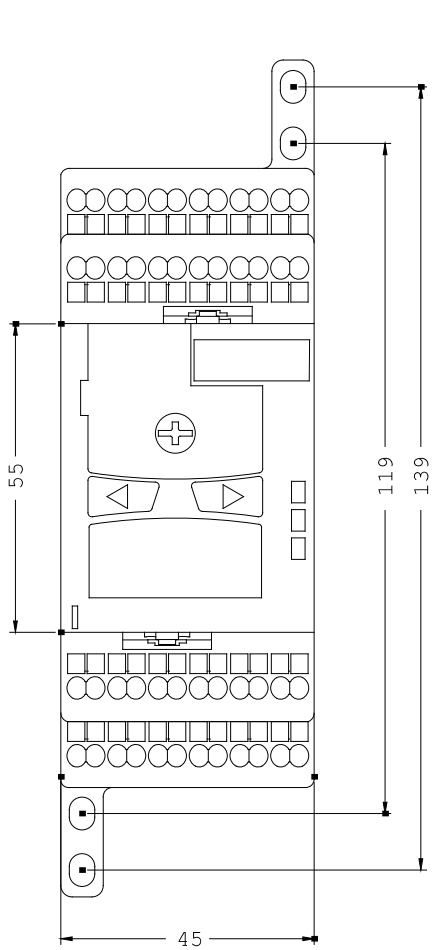

last change:

Jan 25, 2013