



TEMPERATURE MONITORING RELAY THERMOCOUPLE  
 J,  
 T, E, K, N 2 THRESH. VAL.,  
 DIGITAL -99 C - 999 C,  
 24V AC/DC 2 X 1 W + 1 NO,  
 WIDTH 45 MM CAGE-CLAMP - CONNECTION

**General technical details:**



<b>type of voltage</b>		AC/DC
<b>Supply voltage frequency</b>		
<ul style="list-style-type: none"> <li>• 1 / for auxiliary and control current circuit</li> </ul>		
<ul style="list-style-type: none"> <li>• initial rated value</li> </ul>	Hz	50
<ul style="list-style-type: none"> <li>• final rated value</li> </ul>	Hz	60
<ul style="list-style-type: none"> <li>• 1 / at 50 Hz / for AC / rated value</li> </ul>	V	24
<ul style="list-style-type: none"> <li>• 1 / at 60 Hz / for AC / rated value</li> </ul>	V	24
<ul style="list-style-type: none"> <li>• 1 / for DC / rated value</li> </ul>	V	24
<b>Product function</b>		
<ul style="list-style-type: none"> <li>• defect storage</li> </ul>		Yes
<ul style="list-style-type: none"> <li>• reset external</li> </ul>		Yes
<b>Number of measuring circuits</b>		1
<b>Number of NC contacts / for auxiliary contacts</b>		0
<b>Number of NO contacts / for auxiliary contacts</b>		1
<b>Number of change-over switches / for auxiliary contacts</b>		2
<b>Measurable temperature</b>		
<ul style="list-style-type: none"> <li>• initial value</li> </ul>	°C	-99
<ul style="list-style-type: none"> <li>• final value</li> </ul>	°C	999
<b>Item designation / according to DIN EN 61346-2</b>		K

Item designation / according to DIN 40719 extendable after IEC 204-2 / according to IEC 750		K
Ambient temperature • during operating	°C	-25 ... +60

#### Mechanical design:

Design of the electrical connection • for auxiliary and control current circuit • jumper socket		spring-loaded terminals Yes
Design of the sensor / connectable		type J, K, T, E, N (thermocouple)
Width	mm	45
Height	mm	108
Depth	mm	91

#### Certificates/approvals:

General Product Approval	Test Certificates	other	
 CCC	 GOST	<a href="#">Special Test Certificate</a>	<a href="#">Declaration of Conformity</a>
			<a href="#">Environmental Confirmations</a>

#### Further information:

##### Information- and Downloadcenter (Catalogs, Brochures,...)

<http://www.siemens.com/industrial-controls/catalogs>

##### Industry Mall (Online ordering system)

<http://www.siemens.com/industrial-controls/mall>

##### Cax online generator:

<http://www.siemens.com/cax>

##### Service&Support (Manuals, Certificates, Characteristics, FAQs,...)

<http://support.automation.siemens.com/WW/view/en/3RS1140-2GD60/all>

##### Image database (product images, 2D dimension drawings, 3D models, device circuit diagrams, ...)

[http://www.automation.siemens.com/bilddb/cax\\_en.aspx?mlfb=3RS1140-2GD60](http://www.automation.siemens.com/bilddb/cax_en.aspx?mlfb=3RS1140-2GD60)

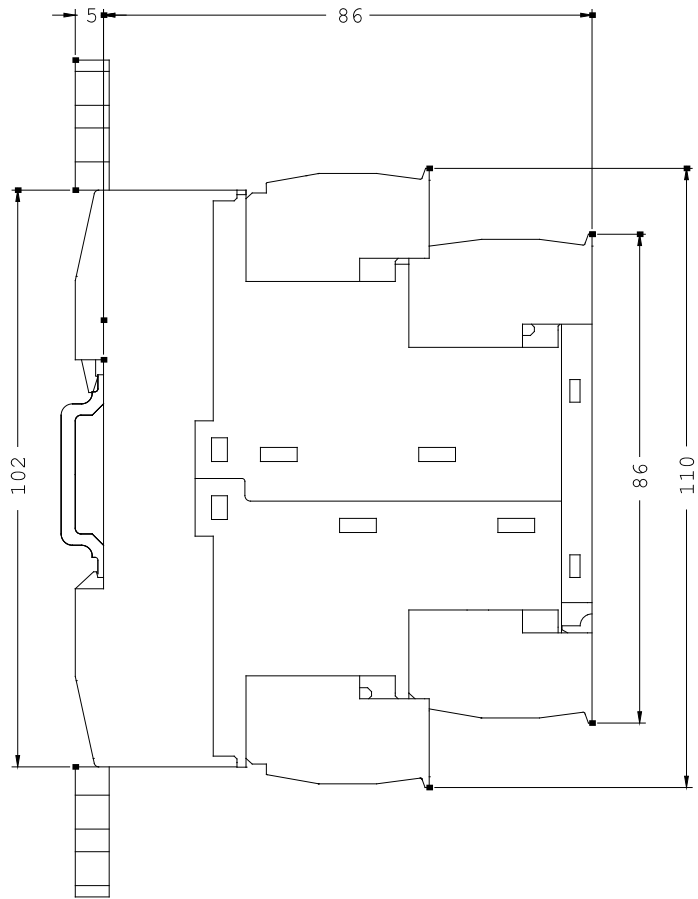
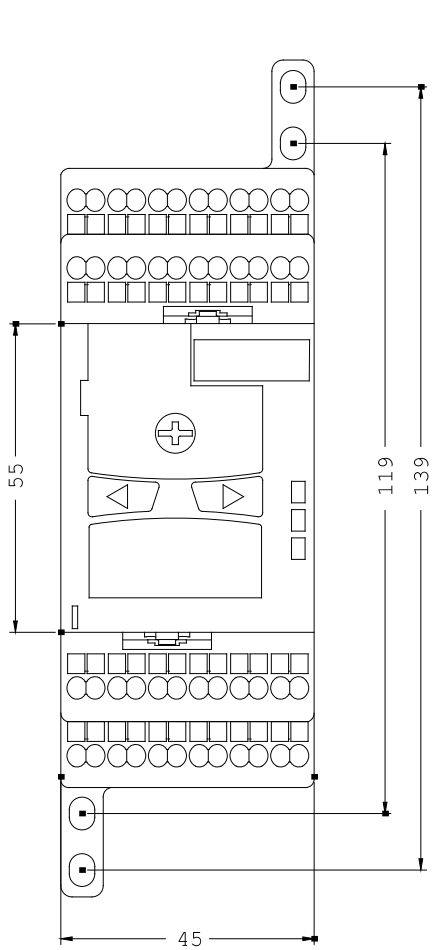

last change:

Jan 25, 2013