



TEMPERATURE MONITORING RELAY THERMOCOUPLE  
 J,K,T,E,N,S,R,B,  
 2 THRESHOLDS, DIGITAL,  
 -99 DEGREES C TO 1800 DEGREES C (SENSOR-  
 DEPENDENT),  
 24 V AC/DC, 2 X 1 CO + 1 NO,  
 WIDTH 45 MM, SCREW TERMINAL

**General technical details:**

|   |                         |                            |
|---|-------------------------|----------------------------|
| <b>type of voltage</b>  |                         | AC/DC                      |
| <b>Supply voltage frequency</b>   |                         |                            |
| <ul style="list-style-type: none"> <li>• 1 / for auxiliary and control current circuit</li> <li>• initial rated value</li> <li>• final rated value</li> <li>• 1 / at 50 Hz / for AC / rated value</li> <li>• 1 / at 60 Hz / for AC / rated value</li> <li>• 1 / for DC / rated value</li> </ul> | Hz<br>Hz<br>V<br>V<br>V | 50<br>60<br>24<br>24<br>24 |
| <b>Product function</b>   |                         |                            |
| <ul style="list-style-type: none"> <li>• defect storage</li> <li>• reset external</li> </ul>  |                         | Yes<br>Yes                 |
| <b>Number of measuring circuits</b>   |                         | 1                          |
| <b>Number of NC contacts / for auxiliary contacts</b>   |                         | 0                          |
| <b>Number of NO contacts / for auxiliary contacts</b>   |                         | 1                          |
| <b>Number of change-over switches / for auxiliary contacts</b>  |                         | 2                          |
| <b>Measurable temperature</b>   |                         |                            |
| <ul style="list-style-type: none"> <li>• initial value</li> <li>• final value</li> </ul>  | °C<br>°C                | -99<br>1,800               |
| <b>Item designation / according to DIN EN 61346-2</b>   |                         | K                          |

|  |    |             |
|--|----|-------------|
| <b>Item designation / according to DIN 40719 extendable after IEC 204-2 / according to IEC 750</b> |    | K           |
| <b>Ambient temperature</b><br>• during operating   | °C | -25 ... +60 |

### Mechanical design:

|  |    |                                   |
|--|----|-----------------------------------|
| <b>Design of the electrical connection</b><br>• for auxiliary and control current circuit<br>• jumper socket |    | screw-type terminals<br>Yes       |
| <b>Design of the sensor / connectable</b>  |    | type J, K, T, E, N (thermocouple) |
| <b>Width</b>   | mm | 45                                |
| <b>Height</b>  | mm | 106                               |
| <b>Depth</b>   | mm | 91                                |

### Certificates/approvals:

| General Product Approval  | other                                       |
|---|---|
| <br>CCC  | <a href="#">Declaration of Conformity</a>   |
| <br>GOST | <a href="#">Environmental Confirmations</a> |
| <br>UL   |   |

### Further information:

|   |
|---|
| <b>Information- and Downloadcenter (Catalogs, Brochures,...)</b><br><a href="http://www.siemens.com/industrial-controls/catalogs">http://www.siemens.com/industrial-controls/catalogs</a>   |
| <b>Industry Mall (Online ordering system)</b><br><a href="http://www.siemens.com/industrial-controls/mall">http://www.siemens.com/industrial-controls/mall</a>  |
| <b>Cax online generator:</b><br><a href="http://www.siemens.com/cax">http://www.siemens.com/cax</a>   |
| <b>Service&amp;Support (Manuals, Certificates, Characteristics, FAQs,...)</b><br><a href="http://support.automation.siemens.com/WW/view/en/3RS1142-1GD80/all">http://support.automation.siemens.com/WW/view/en/3RS1142-1GD80/all</a>                                    |
| <b>Image database (product images, 2D dimension drawings, 3D models, device circuit diagrams, ...)</b><br><a href="http://www.automation.siemens.com/bilddb/cax_en.aspx?mlfb=3RS1142-1GD80">http://www.automation.siemens.com/bilddb/cax_en.aspx?mlfb=3RS1142-1GD80</a> |

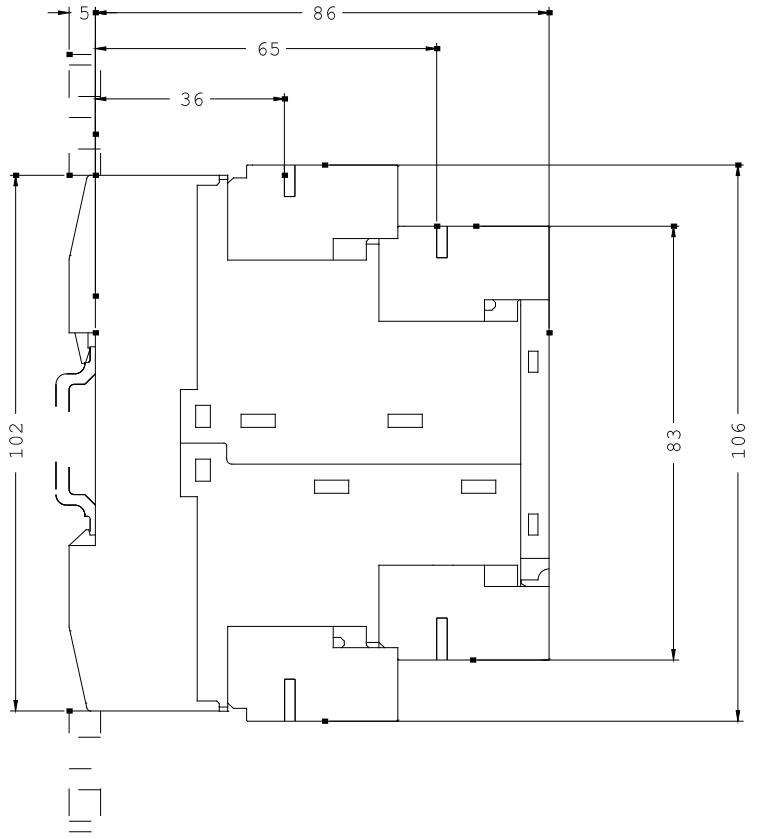
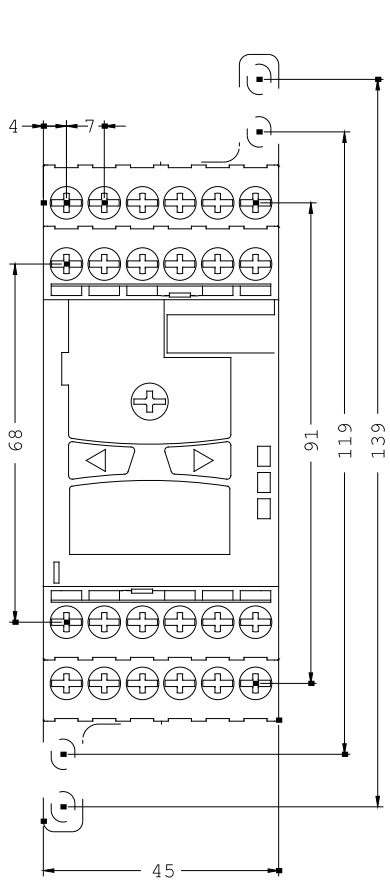

last change:

Jan 25, 2013