



TEMPERATURE MONITORING RELAY THERMOCOUPLE
 J,K,T,E,N,S,R,B,
 2 THRESHOLDS, DIGITAL,
 -99 DEGREES C TO 1800 DEGREES C (SENSOR-
 DEPENDENT),
 24 V AC/DC, 2 X 1 CO + 1 NO,
 WIDTH 45 MM,

General technical details:



| | | |
|---|----|-------|
| type of voltage | | AC/DC |
| Supply voltage frequency | | |
| <ul style="list-style-type: none"> • 1 / for auxiliary and control current circuit | | |
| <ul style="list-style-type: none"> • initial rated value | Hz | 50 |
| <ul style="list-style-type: none"> • final rated value | Hz | 60 |
| <ul style="list-style-type: none"> • 1 / at 50 Hz / for AC / rated value | V | 24 |
| <ul style="list-style-type: none"> • 1 / at 60 Hz / for AC / rated value | V | 24 |
| <ul style="list-style-type: none"> • 1 / for DC / rated value | V | 24 |
| Product function | | |
| <ul style="list-style-type: none"> • defect storage | | Yes |
| <ul style="list-style-type: none"> • reset external | | Yes |
| Number of measuring circuits | | 1 |
| Number of NC contacts / for auxiliary contacts | | 0 |
| Number of NO contacts / for auxiliary contacts | | 1 |
| Number of change-over switches / for auxiliary contacts | | 2 |
| Measurable temperature | | |
| <ul style="list-style-type: none"> • initial value | °C | -99 |
| <ul style="list-style-type: none"> • final value | °C | 1,800 |
| Item designation / according to DIN EN 61346-2 | | K |

| | | |
|--|----|-------------|
| Item designation / according to DIN 40719 extendable after IEC 204-2 / according to IEC 750 | | K |
| Ambient temperature • during operating | °C | -25 ... +60 |

Mechanical design:

| | | |
|--|----|-----------------------------------|
| Design of the electrical connection • for auxiliary and control current circuit • jumper socket | | spring-loaded terminals Yes |
| Design of the sensor / connectable | | type J, K, T, E, N (thermocouple) |
| Width | mm | 45 |
| Height | mm | 108 |
| Depth | mm | 91 |

Certificates/approvals:

| General Product Approval | other |
|--|---|
|  CCC |  GOST |
| | Declaration of Conformity |
| | Environmental Confirmations |

Further information:

Information- and Downloadcenter (Catalogs, Brochures,...)

<http://www.siemens.com/industrial-controls/catalogs>

Industry Mall (Online ordering system)

<http://www.siemens.com/industrial-controls/mall>

Cax online generator:

<http://www.siemens.com/cax>

Service&Support (Manuals, Certificates, Characteristics, FAQs,...)

<http://support.automation.siemens.com/WW/view/en/3RS1142-2GD80/all>

Image database (product images, 2D dimension drawings, 3D models, device circuit diagrams, ...)

http://www.automation.siemens.com/bilddb/cax_en.aspx?mlfb=3RS1142-2GD80

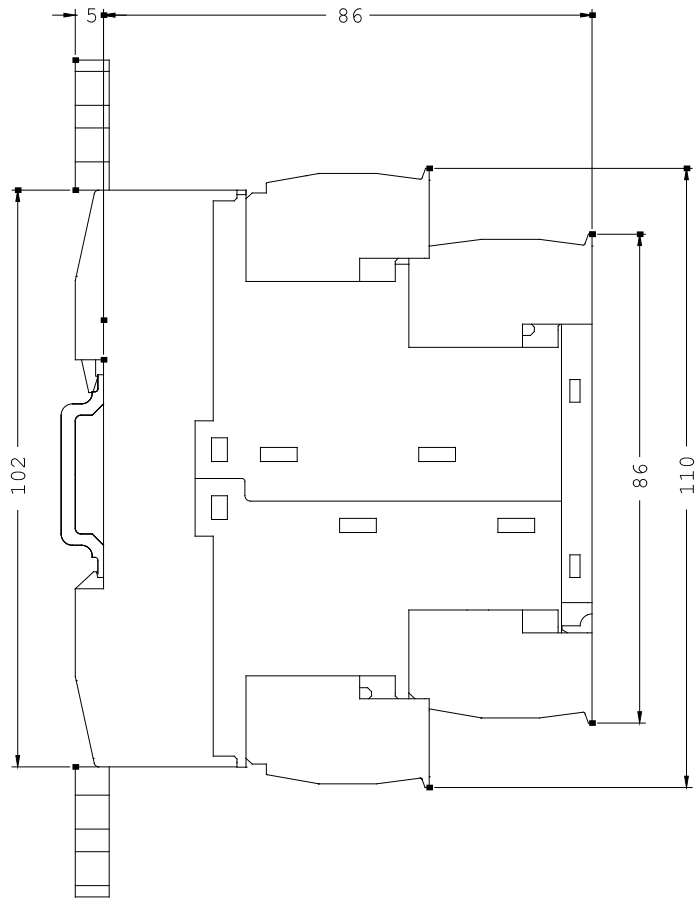
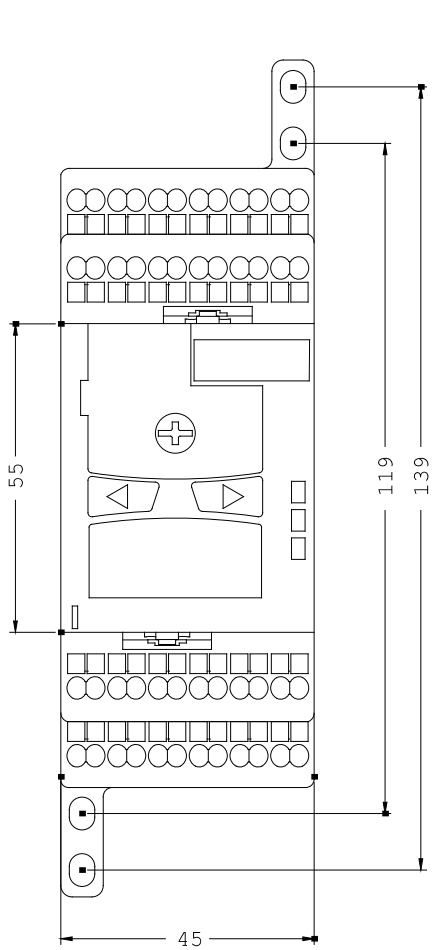

last change:

Jan 25, 2013