



TEMPERATURE MONITORING RELAY PT100/1000
 KTY83/84,
 NTC 2 THRESHOLD VALUES,
 DIGITAL -58 DEGR.F TO 932 DEGR.F 24V AC/DC 2 X 1 CC
 + 1 NO,
 WIDTH 45 MM SCREW CONNECTION

General technical details:

| | | |
|--|----|-------|
| type of voltage | | AC/DC |
| Supply voltage frequency | | |
| <ul style="list-style-type: none"> • 1 / for auxiliary and control current circuit • initial rated value • final rated value | Hz | 50 |
| | Hz | 60 |
| Control supply voltage | | |
| <ul style="list-style-type: none"> • 1 • at 50 Hz / for AC • rated value • at 60 Hz / for AC • rated value • for DC • rated value | V | 24 |
| | V | 24 |
| | V | 24 |
| Number of measuring circuits | | 1 |
| Number of NC contacts / for auxiliary contacts | | 0 |
| Number of NO contacts / for auxiliary contacts | | 1 |
| Number of change-over switches / for auxiliary contacts | | 2 |
| Product function | | |
| <ul style="list-style-type: none"> • defect storage | | Yes |

| | | |
|--|----|-------------|
| • reset external | | Yes |
| Measurable Fahrenheit-temperature | | |
| • initial value | °F | -58 |
| • final value | °F | 932 |
| Item designation / according to DIN EN 61346-2 | | K |
| Item designation / according to DIN 40719 extendable after IEC 204-2 / according to IEC 750 | | K |
| Ambient temperature | | |
| • during operating | °C | -25 ... +60 |

Mechanical design:

| | | |
|---|----|--|
| Design of the electrical connection | | |
| • for auxiliary and control current circuit | | screw-type terminals |
| • jumper socket | | Yes |
| Design of the sensor / connectable | | PT100/1000, KTY83/84, NTC (resistance sensors) |
| Width | mm | 45 |
| Height | mm | 106 |
| Depth | mm | 91 |

Certificates/approvals:

| General Product Approval | Test Certificates | other | | |
|---|---|--|---|---|
|  GOST |  UL | Special Test Certificate | Declaration of Conformity | Environmental Confirmations |

Further information:

Information- and Downloadcenter (Catalogs, Brochures,...)

<http://www.siemens.com/industrial-controls/catalogs>

Industry Mall (Online ordering system)

<http://www.siemens.com/industrial-controls/mall>

CAX-Online-Generator

<http://www.siemens.com/cax>

Service&Support (Manuals, Certificates, Characteristics, FAQs,...)

<http://support.automation.siemens.com/WW/view/en/3RS2040-1GD50/all>

Image database (product images, 2D dimension drawings, 3D models, device circuit diagrams, ...)

http://www.automation.siemens.com/bilddb/cax_en.aspx?mlfb=3RS2040-1GD50

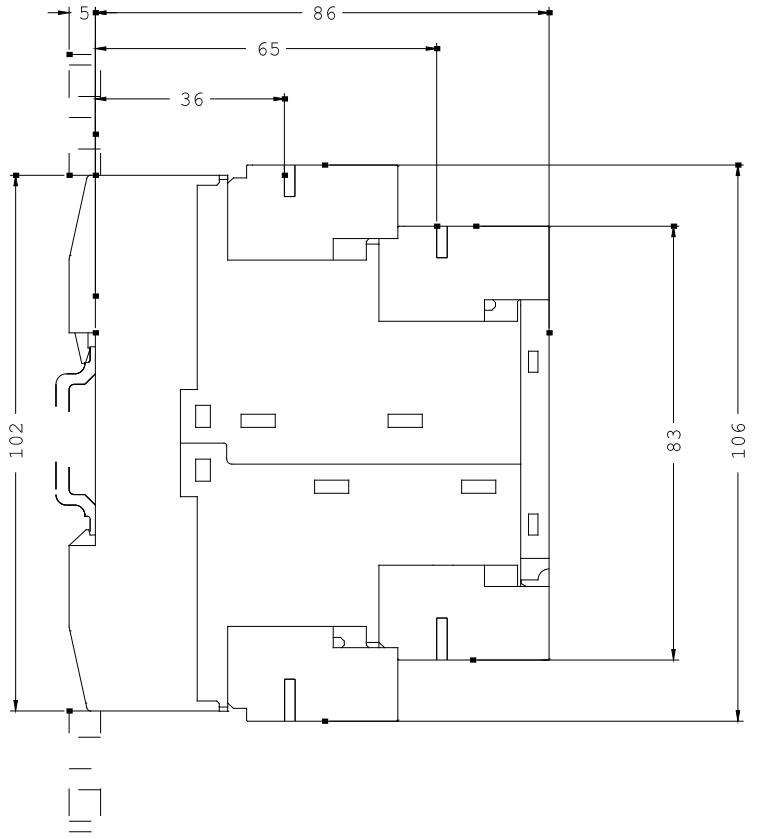
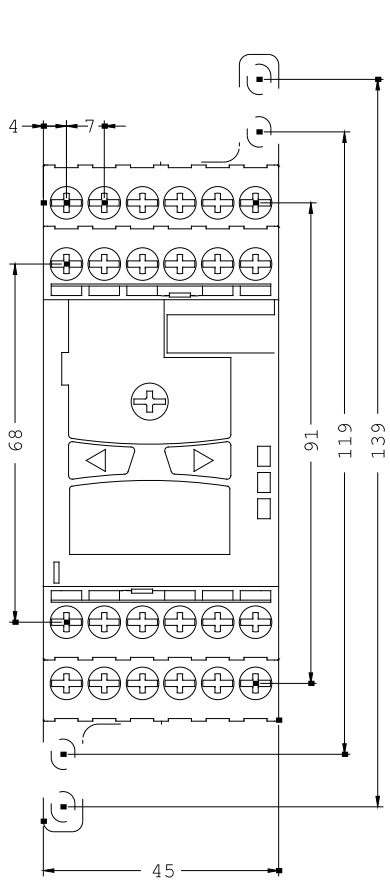

last change:

Jan 25, 2013