



TEMPERATURE MONITORING RELAY PT100/1000,
 KTY83/84, NTC 2 THRESHOLD VALUES,
 DIGITAL -58 DEGR.F TO 932 DEGR.F 24-240V AC/DC 2 X
 1 CC + 1 NO,
 WIDTH 45 MM SCREW CONNECTION

General technical details:		
type of voltage		AC/DC
Supply voltage frequency		
<ul style="list-style-type: none"> • 1 / for auxiliary and control current circuit 		
<ul style="list-style-type: none"> • initial rated value 	Hz	50
<ul style="list-style-type: none"> • final rated value 	Hz	60
Control supply voltage		
<ul style="list-style-type: none"> • 1 		
<ul style="list-style-type: none"> • at 50 Hz / for AC 		
<ul style="list-style-type: none"> <ul style="list-style-type: none"> • initial rated value 	V	24
<ul style="list-style-type: none"> <ul style="list-style-type: none"> • final rated value 	V	240
<ul style="list-style-type: none"> • at 60 Hz / for AC 		
<ul style="list-style-type: none"> <ul style="list-style-type: none"> • initial rated value 	V	24
<ul style="list-style-type: none"> <ul style="list-style-type: none"> • final rated value 	V	240
<ul style="list-style-type: none"> • for DC 		
<ul style="list-style-type: none"> <ul style="list-style-type: none"> • initial rated value 	V	24
<ul style="list-style-type: none"> <ul style="list-style-type: none"> • final rated value 	V	240
Number of measuring circuits		1
Number of NC contacts / for auxiliary contacts		0
Number of NO contacts / for auxiliary contacts		1

Number of change-over switches / for auxiliary contacts		2
Product function		
• defect storage		Yes
• reset external		Yes
Measurable Fahrenheit-temperature		
• initial value	°F	-58
• final value	°F	932
Item designation / according to DIN EN 61346-2		K
Item designation / according to DIN 40719 extendable after IEC 204-2 / according to IEC 750		K
Ambient temperature		
• during operating	°C	-25 ... +60

Mechanical design:

Design of the electrical connection		
• for auxiliary and control current circuit		screw-type terminals
• jumper socket		Yes
Design of the sensor / connectable		PT100/1000, KTY83/84, NTC (resistance sensors)
Width	mm	45
Height	mm	106
Depth	mm	91

Certificates/approvals:

General Product Approval



GOST



UL

Test Certificates

[Special Test Certificate](#)

other

[Declaration of Conformity](#)

[Environmental Confirmations](#)

Further information:

Information- and Downloadcenter (Catalogs, Brochures,...)

<http://www.siemens.com/industrial-controls/catalogs>

Industry Mall (Online ordering system)

<http://www.siemens.com/industrial-controls/mall>

CAX-Online-Generator

<http://www.siemens.com/cax>

Service&Support (Manuals, Certificates, Characteristics, FAQs,...)

<http://support.automation.siemens.com/WW/view/en/3RS2040-1GW50/all>

Image database (product images, 2D dimension drawings, 3D models, device circuit diagrams, ...)

http://www.automation.siemens.com/bilddb/cax_en.aspx?mlfb=3RS2040-1GW50

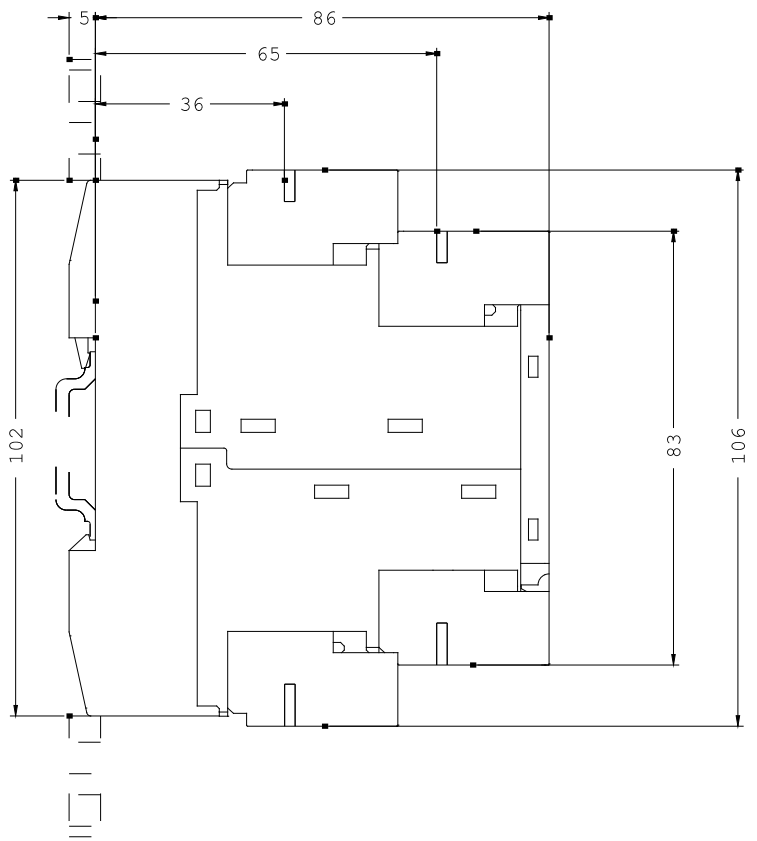
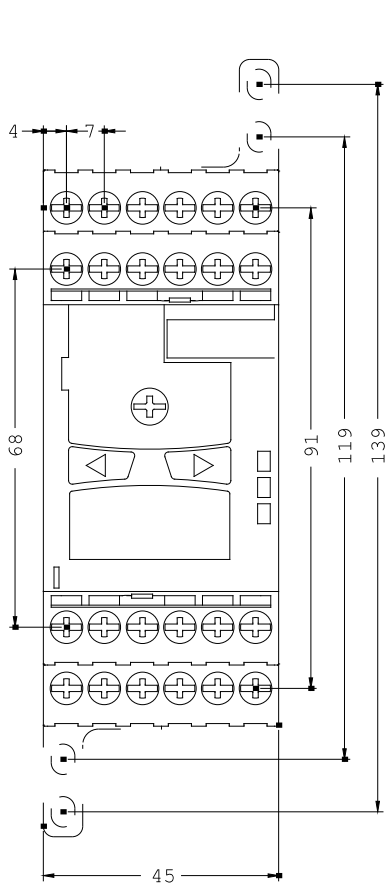

last change:

Jan 25, 2013